

Product Specifications

1.5 Watt AC or DC G4 Spot Lamp

SKU: L-G4-1.5W-CW-360-ACDC-PE (Cool White)
L-G4-1.5W-WW-360-ACDC-PE (Warm White)



G4 1.5 Watt 12V

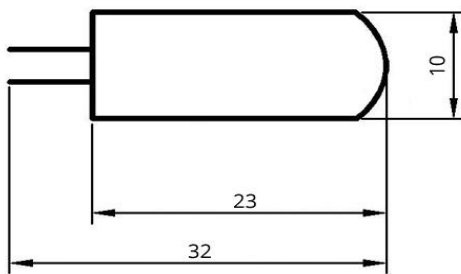

Light Output cool white (Lumens)	145
Light Output warm white (Lumens)	119
Power Consumption (watts)	1.5
Supply voltage (AC/DC)	12
Base Type	G4
Size (mm) Diameter,Height	10,32
Certification	CE, RoHS
IP Grade	IP20 (indoor)
Colour rendering Index (CRI)	Ra≥80
Colour Temp (°K) - Cool White	6000-6500
Colour Temp (°K) - Warm White	2700-3500
Beam Angle (°) Warm White	360
Beam Angle (°) Warm White	360
Body Material	PC
Dimmable	No

DIMMABLE LED LIGHTS -

You can dim LED lights but only if they are specifically identified as 'dimnable' and you are using a dimmer switch designed to work with LED's. You can not use a resistive load style dimmer that is used for tungsten fillament bulbs without running the risk of cuasing your LED light so suffer premature failure. Even running this type of dimmer at the 'full on' position won't work.

All efforts have been made to ensure the accuracy of the information we provide.

Specifications can and do change. If you are unsure or need clarification/confirmation of any specification information please get in touch with our Customer Support Team who will assist you.

Product and application images are provided to give an example view of the item or its use. The product images may not be exactly the same as the product you receive. Please read carefully the product description & specifications to verify your purchase.

If you believe there is an error in the information please contact us by email advising us of the error so they we can endeavour to clarify and correct it.